

Tree Protection Notes

Prior to site disturbance the owner must confirm that no migratory birds are making use of the site for nesting. The owner must ensure that the works are in conformance with the Migratory Bird Convention Act and that no migratory bird nests will be impacted by the proposed work. It is the applicants responsibility to discuss potential tree injury or trees on shared property lines with their neighbours. Should such trees be injured to the point of instability or death the applicant may be held responsible for removal and such issues would be dealt with in civil court or through negotiation. The applicant would be required to replace such trees to the satisfaction of Urban Forestry.

TREE PROTECTION ZONE:
No construction activity including grade changes, surface treatments or excavations of any kind is permitted within the area identified on the Tree Protection Plan or Site Plan as a Tree Protection Zone (TPZ). No root cutting is permitted. No storage of materials or fill is permitted within the TPZ. No movement or storage of vehicles or equipment is permitted within the TPZ. The area(s) identified as a TPZ must remain undisturbed at all times.

TREE PROTECTION BARRIERS:
For City-owned Trees:
Tree protection barriers for trees situated on the City road allowance where visibility must be maintained, can be 1.2m (4ft.) high and consist of chain link, or orange plastic web snow fencing on a 2"x 4" wood frame. All supports and bracing used to secure the barrier should be located outside the TPZ. All support and bracing should minimize damage to roots outside the TPZ. Where some fill or excavate has to be temporarily located near a tree protection barrier, plywood must be used to ensure no material enters the TPZ. If the TPZ needs to be reduced to facilitate construction access, the tree protection barrier must be maintained at a lesser distance and the exposed TPZ protected with plywood and wood chips. This must first be approved by Urban Forestry.

For trees on private property situated on or adjacent to construction sites:
Tree protection barriers must be installed around trees to be protected using plywood clad hoarding or an equivalent approved by Urban Forestry. All supports and bracing to safely secure the barrier should be outside the TPZ. All such supports and bracing should minimize damage to roots outside the TPZ.

Tree Protection Hoarding in the Ravine & Natural Feature Protected Areas:
The applicant/owner shall protect all trees in the protected area that have not been approved for removal or injury, throughout development works to the satisfaction of Urban Forestry. Plywood (or chain link fence, if agreed to by Urban Forestry) tree protection hoarding shall be installed in the locations as indicated in the Urban Forestry approved tree protection plan. Tree protection hoarding shall be installed to standards as detailed in the City's Tree Protection Policy and Specifications for Construction near Trees and to the satisfaction of Urban Forestry. Tree protection hoarding must remain in place and in good condition during demolition and/or construction and must not be altered or moved until authorized by Urban Forestry. Established tree protection zones must not be used as construction access, staging areas or staging areas. Grade changes are not permitted within established TPZ. All additional tree protection or preservation requirements, above and beyond the required tree protection hoarding, must be undertaken or implemented as detailed in the Urban Forestry approved arborist report and/or the approved tree protection plan and to the satisfaction of Urban Forestry. Sediment control fencing shall be installed in the locations as indicated in the Urban Forestry approved sediment control plan. The sediment control fencing must be installed to Ontario Provincial Standards (OPS-219.110) and to the satisfaction of Urban Forestry.

General Note:
Prior to the commencement of any site activity the tree protection barriers specified on this plan must be installed and written notice provided to Urban Forestry. The tree protection barriers must remain in effective condition until all site activities including landscaping are complete. Where required, signs as specified in Section 4 "Tree Protection Signage" must be attached to all sides of the barrier. Written notice must be provided to Urban Forestry prior to the removal of the tree protection barriers.

ARBORICULTURAL WORK:
Any roots or branches which extend beyond the TPZ indicated on this plan which require pruning, must be pruned by a qualified Arborist or other tree professional as approved by Urban Forestry. All pruning of tree roots and branches must be in accordance with good arboricultural standards. Roots located outside the TPZ that have received approval from Urban Forestry to be pruned must first be exposed by hand digging or by using a low pressure hydro vac method. This will allow a proper pruning cut and minimize tearing of the roots. The Arborist/tree professional retained to carry out crown or root pruning must contact Urban Forestry no less than 48 hours prior to conducting any specified work.

TREE PROTECTION ZONE (TPZ) CHART:
The following is a chart showing minimum required distances for determining a Tree Protection Zone (TPZ) for City-owned trees located on a City Street, in parks and trees on private property subject to either the Ravine and Natural Feature Protection By-law or the Private Tree By-law. Some trees and some site conditions may require a larger TPZ.

Table 1 - Tree Protection Zones:

Trunk Diameter (DBH) ¹	Minimum Protection Distances Required ²	Minimum Protection Distances Required ²
City or Private Trees	City or Private Trees	City or Private Trees
Whichever of the two is greater:		
<10	1.2m	The drip line or 1.2 m
10-29	1.8m	The drip line ³ or 1.8 m
30-49	2.4m	The drip line or 2.4 m
50-69	3.0m	The drip line or 3.0 m
70-89	3.6m	The drip line or 3.6 m
90-109	4.2m	The drip line or 4.2 m
110-129	4.8m	The drip line or 4.8 m
130-149	5.4m	The drip line or 5.4 m
150-169	6.0m	The drip line or 6.0 m
> 170	6.6m	The drip line or 6.6 m
6 cm protection for each 1 cm diameter or the drip line ³		

Within a TPZ there must be:
• no construction;
• no altering of grade by adding fill, excavating, trenching, scraping, dumping or disturbance of any kind;
• no storage of construction materials, equipment, soil, construction waste or debris;
• no disposal of any liquids e.g. concrete sludge, gas, oil, paint;
• no movement of vehicles, equipment or pedestrians;
• no parking of vehicles or machinery;
• directional micro-tunnelling and boring may be permitted within the limits of a TPZ subject to approval by Urban Forestry;
• open face cuts outside a TPZ that are consistent with an approved plan and that require root pruning, require the services of a qualified arborist or approved tree professional. An exploratory dig, either by hand or using a low water pressure hydro vac method, must be completed prior to commencing with open face cuts outside the TPZ.

The above mentioned requirements are for area(s) designated as a TPZ. These requirements should also be implemented outside the TPZ in areas where tree roots are located. The roots of a tree can extend from the trunk to approximately 2-3 times the distance of the drip line.

Tree Protection Barriers:
• Plywood tree protection hoarding or steel fence tree protection hoarding shall be installed in locations as detailed in an Urban Forestry approved Tree Protection Plan. Tree protection shall be installed in accordance with the City's Tree Protection Policy and Specifications for Construction near Trees and/or to the satisfaction of Urban Forestry. Within a City road allowance where visibility is a consideration, 1.2m (4ft.) high orange plastic web snow fencing on a 2"x 4" frame should be used.
• All supports and bracing used to safely secure the barrier should be located outside the TPZ. All supports and bracing should minimize damage to roots.
• Where some fill or excavate must be temporarily located near a TPZ, a plywood barrier must be used to ensure no material enters the TPZ.
• Root protection shall be installed where required in construction access locations to the satisfaction of Urban Forestry in order to protect tree roots from compaction during construction. Root protection shall consist of a combination of filter fabric, clear crushed stone (half to three quarter inch diameter) placed in a layer 15cm deep, and steel plating or other material, as approved by Urban Forestry.
• Any area designated for stockpiling of excavated soil must be fenced with sediment control fencing. Sediment control fencing shall be installed in the locations as indicated in an Urban Forestry approved Tree Protection Plan. The sediment control fencing must be installed to Ontario Provincial Standards (OPS-219.110) and to the satisfaction of Urban Forestry. The sediment control fencing can be attached to the tree protection hoarding.
• Once all tree/site protection measures have been installed you must notify Urban Forestry staff to arrange for an inspection of the site and approval of the site protection requirements.
• Where changes to the location of the TPZ or where temporary access to the TPZ are proposed, you must contact Urban Forestry to obtain approval. See Detail TP-1 for further information.

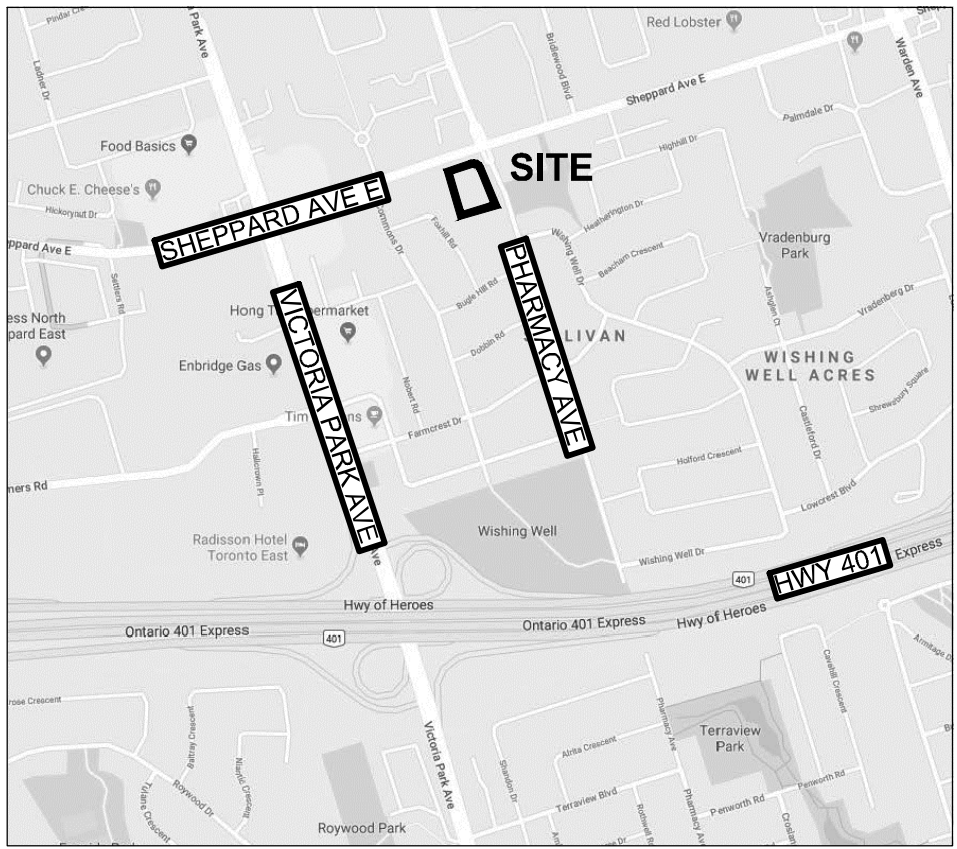
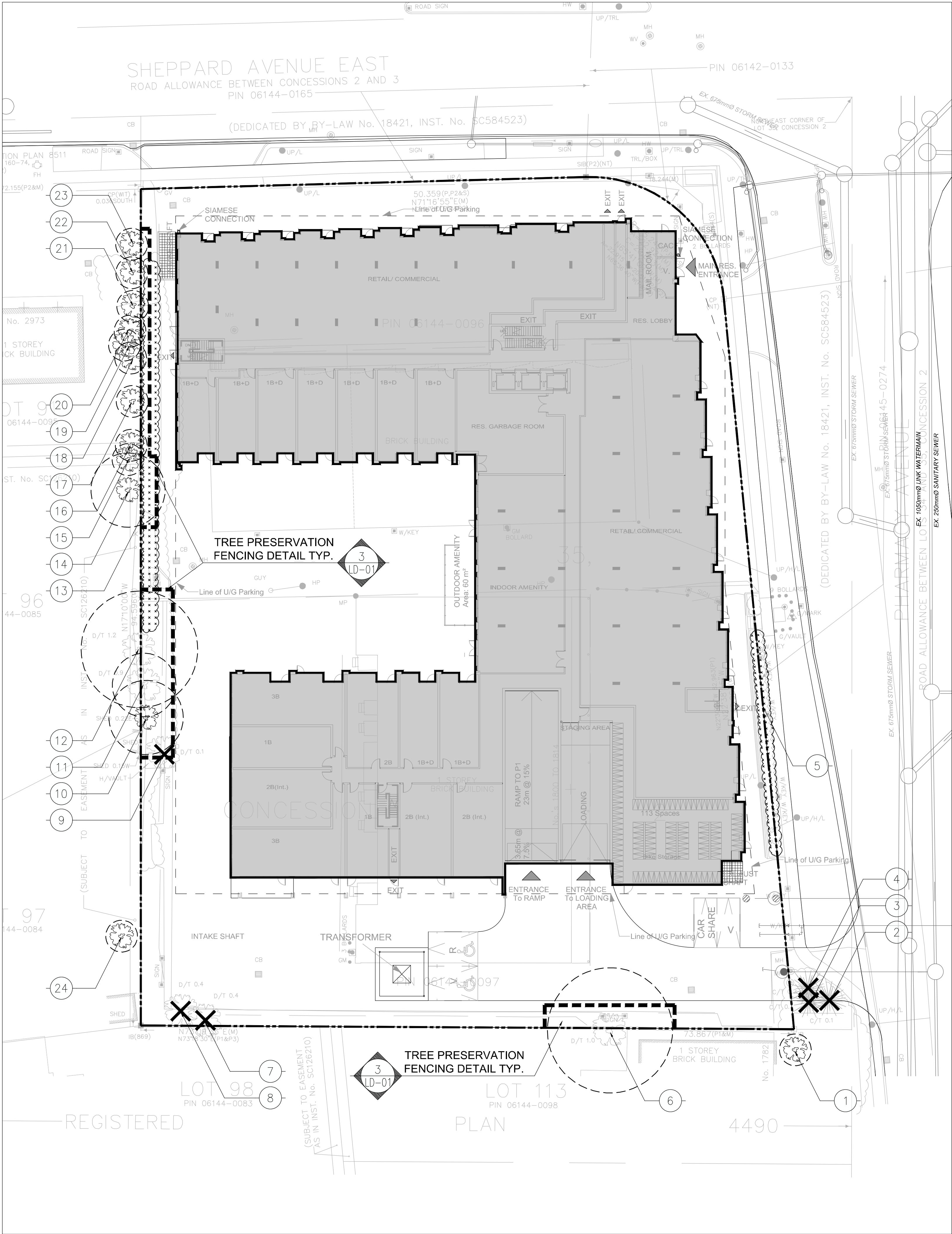

Key Map

Legend

- Existing Deciduous Tree to Remain
- Existing Coniferous Tree to Remain
- Existing Deciduous Tree to be Removed
- Existing Coniferous Tree to be Removed
- Tree Protection Zone (TPZ)
- Property Line
- Tree Protection Fencing
- Detail Reference Key
- Existing Tree Reference Key

Existing Tree Reference List

Tree number (No.), Species, Diameter at Breast Height (DBH), Condition Rating (CR), Toronto Tree Category (TC), & Recommendations

No.	Tree Species	DBH (cm)	CR (%)	TC	Location	Recommendations
#1	Juniper	13	55	5	SE roadside	To be PRESERVED
#2	Juniper	12	60	5	SE roadside	To be REMOVED
#3	Juniper	21	60	5	SE roadside	To be REMOVED
#4	Siberian Elm	8	70	5	SE roadside	To be REMOVED
#5+	Siberian Elm, 12	1-2	60-70	1	E planter	To be REMOVED
#6	Siberian Elm	118	55	2	S south	To be PRESEVED with risk of injury
#7	Manitoba Maple	34-36	55	1	SW corner	To be REMOVED
#8	Norway Maple	39	60	1	SW corner	To be REMOVED
#9	Cherry trees	14	65	1	W side	To be REMOVED
#10	Silver Maple	56-62	50	1	W side	To be PRESEVED with risk of injury
#11	Silver Maple	56	45	1	W side	To be PRESEVED with risk of injury
#12	Silver Maple	98-110	55	2	W side	To be PRESEVED with risk of injury
#13+	White Cedars, 17	5-12	65-70	1	W side	To be REMOVED
#14	Siberian Elm	64	60	2	NW side	To be PRESEVED with risk of injury
#15	Norway Maple	12	65	1	NW side	To be PRESERVED
#16	Norway Maple	10	65	1	NW side	To be PRESERVED
#17	Manitoba Maple	28	65	2	NW off-site	To be PRESERVED
#18	Norway Maple	10-12	70	2	NW off-site	To be PRESERVED
#19	Norway Maple	15	50	2	NW off-site	To be PRESERVED
#20	Norway Maple	28	65	2	NW off-site	To be PRESERVED
#21	Norway Maple	16	70	2	NW off-site	To be PRESERVED
#22	Manitoba Maple	15	65	2	NW off-site	To be PRESERVED
#23	Silver Maple	9-15	65	2	NW off-site	To be PRESERVED
#24	Pear Tree	15-17	55	2	SW off-site	To REMAIN (beyond limit of work)

msla
MARTON SMITH LANDSCAPE ARCHITECTS
170 The Donway W Suite 206,
Toronto, Ontario, Canada, M3C 2G3
tel. 416.492.9966 | email: info@msla.ca

Architect:



KIRKOR ARCHITECTS + PLANNERS

20 De Boers Dr. # 400 Toronto ON M3J 0H1
TEL 416 665 6060 | kirkorarchitects.com

Municipality:



Notes:

05	Issued for Submission	08/01/19
04	Rev. per Site Plan	07/24/19
03	Rev. per Site Plan	07/08/19
02	Rev. per Site Plan	04/25/19
01	Issued for Review	03/27/19

No. Revision Date

North: Stamp:

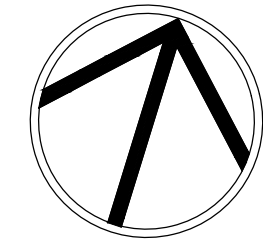

Project:
Proposed Mixed Use Development
3005 Sheppard Ave E, & 1800 Pharmacy Ave
Scarborough, Ontario

Scale: 1:250 Date: Mar. 2019

Drawn By: D.R. Checked By: L.M.

Drawing Title:

Tree Survey & Preservation Plan

Project No. Sheet No.
19110 L1-01

All information contained in these plans shall be checked by the contractor (L.A.) before commencing work. All drawings have copyright and shall remain the property of the Landscape Architect. Copying or any reproduction in part or whole without prior written consent of L.A. Drawing shall not be used for construction unless sealed & SIGNED.
NOTE: FOR ANY AND ALL GRADING INFORMATION REFER TO SITE GRADING ENGINEERING DRAWINGS. NO SLOPES ARE TO EXCEED 3:1. PROPERTY LINES AND SETBACKS MUST BE CONFIRMED BY CONTRACTOR PRIOR TO CONSTRUCTION. ALL REMAINING WALLS MUST BE APPROVED BY STRUCTURAL ENGINEER PRIOR TO CONSTRUCTION. ALL REMAINING WALLS MUST BE APPROVED BY L.A. ARCHITECT. SIGNED DATE